

REV	DATE	DESCRIPTION	DATE	BY	APPD
AD 25					
0		DRAWN; WAS 95-5653-186-1			

- △ HOUSING MATERIAL: GLASS-FILLED POLYESTER. COLOR: GRAY.
- △ CONTACT MATERIAL: PHOSPHOR BRONZE.
- △ CONTACT FINISH: 0.00076[.000030] GOLD IN CONTACT AREA. 0.00127[.000050] NICKEL UNDERPLATE ALL OVER. TIN-LEAD PLATE ON POSTS.
- △ RECOMMENDED HOLE SIZE FOR MANUAL APPLICATION OF CONNECTOR ONTO PC BOARD.
- △ PART NUMBER, DATE CODE IDENTIFICATION, CSA LOGO HOT-STAMPED THIS APPROXIMATE AREA.
- △ CONTACT POINT.
- △ HOT-STAMPING ON THIS SIDE.

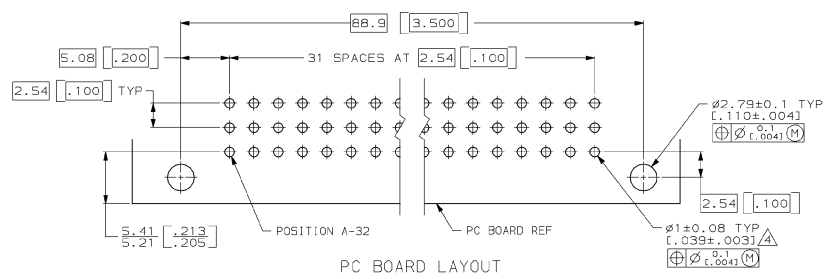
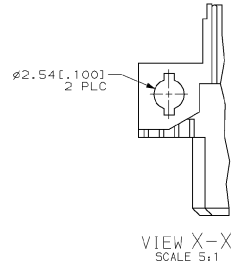
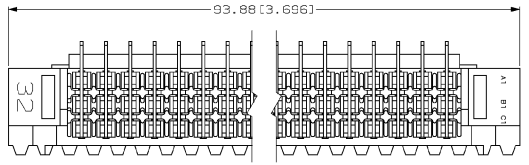
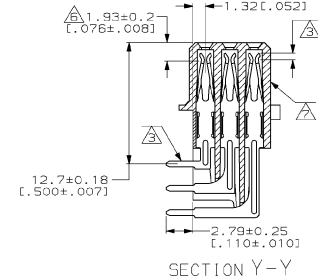
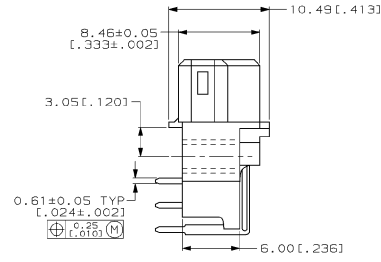
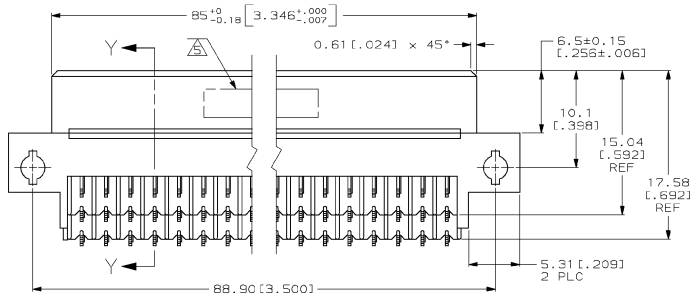
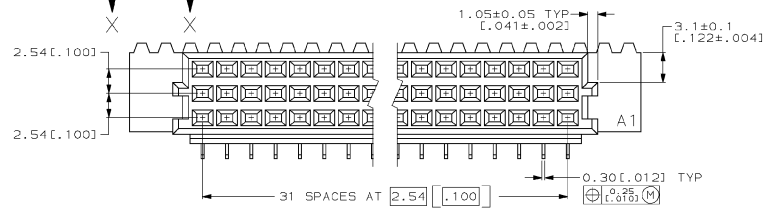

DIMENSIONS:		DATE	REV	DESCRIPTION	DATE	BY	APPD
3	PLC	9/7/75					
4	PLC	9/7/75					
5	PLC	9/7/75					
6	PLC	9/7/75					
7	PLC	9/7/75					
8	PLC	9/7/75					
9	PLC	9/7/75					
10	PLC	9/7/75					
11	PLC	9/7/75					
12	PLC	9/7/75					
13	PLC	9/7/75					
14	PLC	9/7/75					
15	PLC	9/7/75					
16	PLC	9/7/75					
17	PLC	9/7/75					
18	PLC	9/7/75					
19	PLC	9/7/75					
20	PLC	9/7/75					
21	PLC	9/7/75					
22	PLC	9/7/75					
23	PLC	9/7/75					
24	PLC	9/7/75					
25	PLC	9/7/75					
26	PLC	9/7/75					
27	PLC	9/7/75					
28	PLC	9/7/75					
29	PLC	9/7/75					
30	PLC	9/7/75					
31	PLC	9/7/75					
32	PLC	9/7/75					
33	PLC	9/7/75					
34	PLC	9/7/75					
35	PLC	9/7/75					
36	PLC	9/7/75					
37	PLC	9/7/75					
38	PLC	9/7/75					
39	PLC	9/7/75					
40	PLC	9/7/75					
41	PLC	9/7/75					
42	PLC	9/7/75					
43	PLC	9/7/75					
44	PLC	9/7/75					
45	PLC	9/7/75					
46	PLC	9/7/75					
47	PLC	9/7/75					
48	PLC	9/7/75					
49	PLC	9/7/75					
50	PLC	9/7/75					
51	PLC	9/7/75					
52	PLC	9/7/75					
53	PLC	9/7/75					
54	PLC	9/7/75					
55	PLC	9/7/75					
56	PLC	9/7/75					
57	PLC	9/7/75					
58	PLC	9/7/75					
59	PLC	9/7/75					
60	PLC	9/7/75					
61	PLC	9/7/75					
62	PLC	9/7/75					
63	PLC	9/7/75					
64	PLC	9/7/75					
65	PLC	9/7/75					
66	PLC	9/7/75					
67	PLC	9/7/75					
68	PLC	9/7/75					
69	PLC	9/7/75					
70	PLC	9/7/75					
71	PLC	9/7/75					
72	PLC	9/7/75					
73	PLC	9/7/75					
74	PLC	9/7/75					
75	PLC	9/7/75					
76	PLC	9/7/75					
77	PLC	9/7/75					
78	PLC	9/7/75					
79	PLC	9/7/75					
80	PLC	9/7/75					
81	PLC	9/7/75					
82	PLC	9/7/75					
83	PLC	9/7/75					
84	PLC	9/7/75					
85	PLC	9/7/75					
86	PLC	9/7/75					
87	PLC	9/7/75					
88	PLC	9/7/75					
89	PLC	9/7/75					
90	PLC	9/7/75					
91	PLC	9/7/75					
92	PLC	9/7/75					
93	PLC	9/7/75					
94	PLC	9/7/75					
95	PLC	9/7/75					
96	PLC	9/7/75					
97	PLC	9/7/75					
98	PLC	9/7/75					
99	PLC	9/7/75					
100	PLC	9/7/75					